

PZ23-12000054

08/06/2025



Arboriculture Tree Report

3233 Canal Dr Pompano Beach

Name: Mr Michaud
Attn.: Mr Michaud
Address: 3233-3237 Canal Drive
Pompano Beach, Florida

Date: Sept, 8th, 2024
Phone: 561-414-8269
Email: wtonning@tonningandassociates.com

Prepared by: John Sutton
International Society of Arboriculture Certified Arborist

Certification of Performance

I, John Sutton, certify to the best of my knowledge, and abilities.

That I have personally inspected the tree(s) and or the property referred to in this report.

That it is my professional opinion, that the following report is true and the conclusions and results stated are correct based on the information received about the property evaluated and the evaluation methods followed.

That the reported analyses, opinions, and conclusions are only limited by the reported assumptions, methods and limiting conditions and my personal, unbiased professional analyses, opinions and conclusions.

That Sutton Consulting Arborist, Inc. acts as an independent tree, and landscape consultant. This firm has no prospective or current interest in the property evaluated or interest/bias with respect to the parties involved.

That this Report, or parts of this Report, have not been revealed to any party other than the Client named and will not be revealed to any other party unless authorized to do so by Client named or by due process of law or by legally required public testimony by this firm of these results.

This report is written in good faith and all rights are reserved by Sutton Consulting Arborist, Inc. It is for use by the client named only.

PZ23-12000054

Arboriculture consulting work for your property: 3233 Canal Dr Pompano Beach

08/06/2025

I have evaluated all trees/palms located on the referenced property. The purpose of my visit is to evaluate the trees and palms for health and condition. Please see site survey picture with tree locations, excel spreadsheet and pictures below for individual unit's details and location. Trees are tagged with corresponding numbers. Total tree appraisal: \$29,815.29

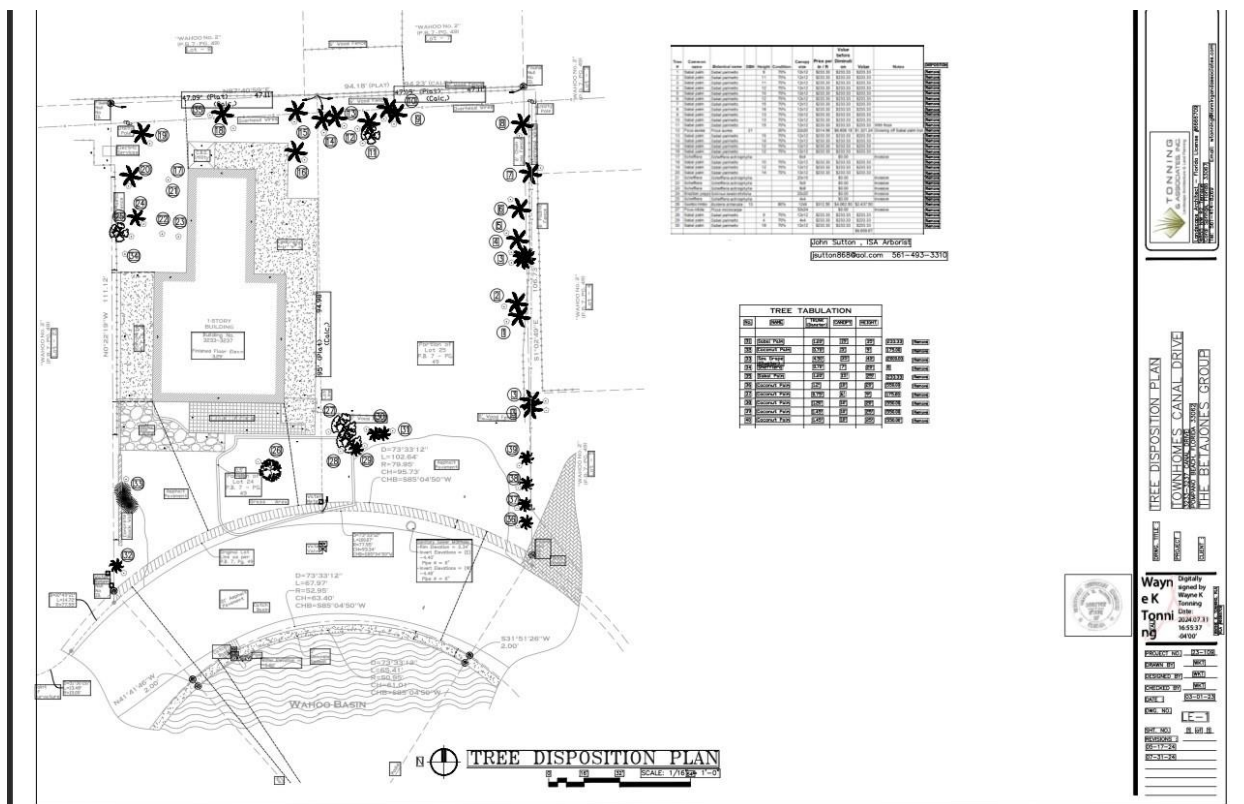

Tree #	Common name	Botanical name	DBH	Height	Condition	Canopy size	Price per in / ft	Value before Diminution	Value	Notes
1	Sabal palm	<i>Sabal palmetto</i>		8	70%	12x12	\$32.99	\$263.92	\$184.74	
2	Sabal palm	<i>Sabal palmetto</i>		11	70%	12x12	\$32.99	\$362.89	\$254.02	
3	Sabal palm	<i>Sabal palmetto</i>		11	70%	12x12	\$32.99	\$362.89	\$254.02	
4	Sabal palm	<i>Sabal palmetto</i>		12	70%	12x12	\$32.99	\$395.88	\$277.12	
5	Sabal palm	<i>Sabal palmetto</i>		10	70%	12x12	\$32.99	\$329.90	\$230.93	
6	Sabal palm	<i>Sabal palmetto</i>		12	70%	12x12	\$32.99	\$395.88	\$277.12	
7	Sabal palm	<i>Sabal palmetto</i>		15	70%	12x12	\$32.99	\$494.85	\$346.40	
8	Sabal palm	<i>Sabal palmetto</i>		18	70%	12x12	\$32.99	\$593.82	\$415.67	
9	Sabal palm	<i>Sabal palmetto</i>		13	70%	12x12	\$32.99	\$428.87	\$300.21	

PZ23-12000054

03/05/2025

PZ23-12000054 08/05/2025	Sabal palm	<i>Sabal palmetto</i>		13	70%	12x12	\$32.99	\$428.87	\$300.21	
Tree #	Common name	Botanical name	DBH	Height	Condition	Canopy size	Price per in / ft	Value before Diminution	Value	Notes
11	Sabal palm	<i>Sabal palmetto</i>		15	70%	12x12	\$32.99	\$494.85	\$346.40	With ficus
12	Ficus aurea	<i>Ficus aurea</i>	21	45	20%	22x20	\$314.58	\$6,606.18	\$1,321.24	Growing off Sabal palm trunk
13	Sabal palm	<i>Sabal palmetto</i>		15	70%	12x12	\$32.99	\$494.85	\$346.40	
14	Sabal palm	<i>Sabal palmetto</i>		14	70%	12x12	\$32.99	\$461.86	\$323.30	
15	Sabal palm	<i>Sabal palmetto</i>		12	70%	12x12	\$32.99	\$395.88	\$277.12	
16	Sabal palm	<i>Sabal palmetto</i>		12	70%	12x12	\$32.99	\$395.88	\$277.12	
17	Schefflera	<i>Schefflera actinophylla</i>	3.5	15		6x4	\$0.00	\$0.00	\$0.00	Invasive
18	Sabal palm	<i>Sabal palmetto</i>		10	70%	12x12	\$32.99	\$329.90	\$230.93	
19	Sabal palm	<i>Sabal palmetto</i>		12	70%	12x12	\$32.99	\$395.88	\$277.12	
20	Sabal palm	<i>Sabal palmetto</i>		14	70%	12x12	\$32.99	\$461.86	\$323.30	
21	Schefflera	<i>Schefflera actinophylla</i>	4	15		20x15	\$0.00	\$0.00	\$0.00	Invasive
22	Schefflera	<i>Schefflera actinophylla</i>	3.5	15		5x5	\$0.00	\$0.00	\$0.00	Invasive
23	Schefflera	<i>Schefflera actinophylla</i>	4	15		8x8	\$0.00	\$0.00	\$0.00	Invasive
24	Brazilian pepper	<i>Schinus terebinthifolia</i>	11	15		20x20	\$0.00	\$0.00	\$0.00	Invasive
25	Schefflera	<i>Schefflera actinophylla</i>	3.5	15		4x4	\$0.00	\$0.00	\$0.00	Invasive
26	Gumbo limbo	<i>Bursera simaruba</i>	14	25	60%	12x9	\$312.50	\$4,375.00	\$2,625.00	
27	Ficus nitida	<i>Ficus microcarpa</i>	45		45%	60x60	\$164.58	\$7,406.10	\$3,332.75	Invasive
28	Sabal palm	<i>Sabal palmetto</i>		9	70%	12x12	\$32.99	\$296.91	\$207.84	
29	Sabal palm	<i>Sabal palmetto</i>		4	70%	4x4	\$32.99	\$131.96	\$92.37	
30	Sabal palm	<i>Sabal palmetto</i>		18	70%	12x12	\$32.99	\$593.82	\$415.67	
31	Sabal palm	<i>Sabal palmetto</i>		25	60%	12x12	\$32.99	\$824.75	\$494.85	Growing through center of Ficus
32	Coconut palm	<i>Cocos nucifera</i>		2	70%	24x24	\$154.17	\$308.34	\$215.84	
33	Sea grape	<i>Coccoloba uvifera</i>	33.5	40	60%	40x40	\$229.17	\$9,166.80	\$4,606.32	Multi stemmed, restricted roots on the east side of the trunk
34	Schefflera	<i>Coccoloba uvifera</i>	4.5	20			\$0.00	\$0.00	\$0.00	Invasive
35	Sabal palm	<i>Sabal palmetto</i>		25	70%	12x12	\$32.99	\$824.75	\$577.33	
36	Coconut palm	<i>Cocos nucifera</i>		20	70%	24x24	\$154.17	\$3,083.40	\$2,158.38	

PZ23-12000054 08/06/2025	Coconut palm	<i>Cocos nucifera</i>		9	70%	24x24	\$154.17	\$1,387.53	\$971.27	
Tree #	Common name	Botanical name	DBH	Height	Condition	Canopy size	Price per in / ft	Value before Diminution	Value	Notes
38	Coconut palm	<i>Cocos nucifera</i>		20	70%	24x24	\$154.17	\$3,083.40	\$2,158.38	
39	Coconut palm	<i>Cocos nucifera</i>		25	70%	24x24	\$154.17	\$3,854.25	\$2,697.98	
40	Coconut palm	<i>Cocos nucifera</i>		25	70%	24x24	\$154.17	\$3,854.25	\$2,697.98	
									\$29,815.29	



1	Sabal palm	<i>Sabal palmetto</i>		8	70%	12x12	\$32.99	\$263.92	\$184.74	
2	Sabal palm	<i>Sabal palmetto</i>		11	70%	12x12	\$32.99	\$362.89	\$254.02	
3	Sabal palm	<i>Sabal palmetto</i>		11	70%	12x12	\$32.99	\$362.89	\$254.02	
4	Sabal palm	<i>Sabal palmetto</i>		12	70%	12x12	\$32.99	\$395.88	\$277.12	
5	Sabal palm	<i>Sabal palmetto</i>		10	70%	12x12	\$32.99	\$329.90	\$230.93	
6	Sabal palm	<i>Sabal palmetto</i>		12	70%	12x12	\$32.99	\$395.88	\$277.12	

PZ23-12000054

08/06/2025



7	Sabal palm	<i>Sabal palmetto</i>		15	70%	12x12	\$32.99	\$494.85	\$346.40	
8	Sabal palm	<i>Sabal palmetto</i>		18	70%	12x12	\$32.99	\$593.82	\$415.67	

PZ23-12000054

03/05/2025

PZ23-12000054

08/06/2025



9	Sabal palm	<i>Sabal palmetto</i>		13	70%	12x12	\$32.99	\$428.87	\$300.21	
10	Sabal palm	<i>Sabal palmetto</i>		13	70%	12x12	\$32.99	\$428.87	\$300.21	
11	Sabal palm	<i>Sabal palmetto</i>		15	70%	12x12	\$32.99	\$494.85	\$346.40	With ficus
12	Ficus aurea	<i>Ficus aurea</i>	21	45	20%	22x20	\$314.58	\$6,606.18	\$1,321.24	Growing off Sabal palm trunk

PZ23-12000054

03/05/2025

PZ23-12000054

08/06/2025



13	Sabal palm	<i>Sabal palmetto</i>		15	70%	12x12	\$32.99	\$494.85	\$346.40	
14	Sabal palm	<i>Sabal palmetto</i>		14	70%	12x12	\$32.99	\$461.86	\$323.30	
15	Sabal palm	<i>Sabal palmetto</i>		12	70%	12x12	\$32.99	\$395.88	\$277.12	
16	Sabal palm	<i>Sabal palmetto</i>		12	70%	12x12	\$32.99	\$395.88	\$277.12	

PZ23-12000054

03/05/2025

PZ23-12000054
08/06/2025



17	Schefflera	<i>Schefflera actinophylla</i>	3.5	15		6x4	\$0.00	\$0.00	\$0.00	Invasive
----	------------	--------------------------------	-----	----	--	-----	--------	--------	--------	----------

PZ23-12000054
08/06/2025



18	Sabal palm	<i>Sabal palmetto</i>		10	70%	12x12	\$32.99	\$329.90	\$230.93	
----	------------	-----------------------	--	----	-----	-------	---------	----------	----------	--

PZ23-12000054

08/06/2025



19	Sabal palm	<i>Sabal palmetto</i>		12	70%	12x12	\$32.99	\$395.88	\$277.12	
20	Sabal palm	<i>Sabal palmetto</i>		14	70%	12x12	\$32.99	\$461.86	\$323.30	

PZ23-12000054

03/05/2025

PZ23-12000054
08/06/2025



21	Schefflera	<i>Schefflera actinophylla</i>	4	15		20x15	\$0.00	\$0.00	\$0.00	Invasive
----	------------	--------------------------------	---	----	--	-------	--------	--------	--------	----------

PZ23-12000054
08/06/2025



22	Schefflera	<i>Schefflera actinophylla</i>	3.5	15		5x5	\$0.00	\$0.00	\$0.00	Invasive
23	Schefflera	<i>Schefflera actinophylla</i>	4	15		8x8	\$0.00	\$0.00	\$0.00	Invasive

PZ23-12000054
08/06/2025



24	Brazilian pepper	<i>Schinus terebinthifolia</i>	11	15		20x20	\$0.00	\$0.00	\$0.00	Invasive
----	------------------	--------------------------------	----	----	--	-------	--------	--------	--------	----------

PZ23-12000054
08/06/2025



25	Schefflera	<i>Schefflera actinophylla</i>	3.5	15		4x4	\$0.00	\$0.00	\$0.00	Invasive
----	------------	--------------------------------	-----	----	--	-----	--------	--------	--------	----------

PZ23-12000054
08/06/2025



26	Gumbo limbo	Bursera simaruba	14	25	60%	12x9	\$312.50	\$4,375.00	\$2,625.00	
----	----------------	---------------------	----	----	-----	------	----------	------------	------------	--

PZ23-12000054
08/06/2025



27	Ficus nitida	Ficus microcarpa	45		45%	60x60	\$164.58	\$7,406.10	\$3,332.75	Invasive
----	--------------	------------------	----	--	-----	-------	----------	------------	------------	----------

PZ23-12000054
08/06/2025



28	Sabal palm	<i>Sabal palmetto</i>		9	70%	12x12	\$32.99	\$296.91	\$207.84	
----	------------	-----------------------	--	---	-----	-------	---------	----------	----------	--

PZ23-12000054
08/06/2025



29	Sabal palm	<i>Sabal palmetto</i>		4	70%	4x4	\$32.99	\$131.96	\$92.37	
30	Sabal palm	<i>Sabal palmetto</i>		18	70%	12x12	\$32.99	\$593.82	\$415.67	

PZ23-12000054
08/06/2025



31	Sabal palm	<i>Sabal palmetto</i>		25	60%	12x12	\$32.99	\$824.75	\$494.85	Growing through center of Ficus
----	------------	-----------------------	--	----	-----	-------	---------	----------	----------	---------------------------------

PZ23-12000054
08/06/2025



32	Coconut palm	<i>Cocos nucifera</i>		2	70%	24x24	\$154.17	\$308.34	\$215.84	
----	--------------	-----------------------	--	---	-----	-------	----------	----------	----------	--

PZ23-12000054

08/06/2025



33	Sea grape	<i>Coccoloba uvifera</i>	33.5	40	60%	40x40	\$229.17	\$9,166.80	\$4,606.32	Multi stemmed, restricted roots on the east side of the trunk
----	-----------	--------------------------	------	----	-----	-------	----------	------------	------------	---

PZ23-12000054

03/05/2025

PZ23-12000054

08/06/2025



33	Sea grape	<i>Coccoloba uvifera</i>	33.5	40	60%	40x40	\$229.17	\$9,166.80	\$4,606.32	Multi stemmed, restricted roots on the east side of the trunk
----	-----------	--------------------------	------	----	-----	-------	----------	------------	------------	---

PZ23-12000054

03/05/2025

PZ23-12000054
08/06/2025



34	Schefflera	<i>Coccoloba uvifera</i>	4.5	20			\$0.00	\$0.00	\$0.00	Invasive
----	------------	--------------------------	-----	----	--	--	--------	--------	--------	----------

PZ23-12000054
03/05/2025

PZ23-12000054
08/06/2025



35	Sabal palm	<i>Sabal palmetto</i>		25	70%	12x12	\$32.99	\$824.75	\$577.33	
----	------------	-----------------------	--	----	-----	-------	---------	----------	----------	--

PZ23-12000054
03/05/2025

PZ23-12000054

08/06/2025



36	Coconut palm	<i>Cocos nucifera</i>		20	70%	24x24	\$154.17	\$3,083.40	\$2,158.38	
37	Coconut palm	<i>Cocos nucifera</i>		9	70%	24x24	\$154.17	\$1,387.53	\$971.27	
38	Coconut palm	<i>Cocos nucifera</i>		20	70%	24x24	\$154.17	\$3,083.40	\$2,158.38	
39	Coconut palm	<i>Cocos nucifera</i>		25	70%	24x24	\$154.17	\$3,854.25	\$2,697.98	
40	Coconut palm	<i>Cocos nucifera</i>		25	70%	24x24	\$154.17	\$3,854.25	\$2,697.98	
									\$29,815.29	

Please feel free to contact me should you have any questions.

In Support

John Sutton

John Sutton/Sutton Consulting Arborist

ISA Certified Arborist #SO-0326A

TRAQ Qualified

Sutton Consulting Arborist is staffed by professional Arborists, Horticulturists, and Landscape Inspectors. We utilize associates with expertise in their fields to provide the most accurate, efficient and useful information available to clients. We stand behind our work and can additionally answer any questions or fulfill needs for additional information or services.

PZ23-12000054

03/05/2025